

accessories and fitting systems

Lux Economic L-Type Cabinet Hanger

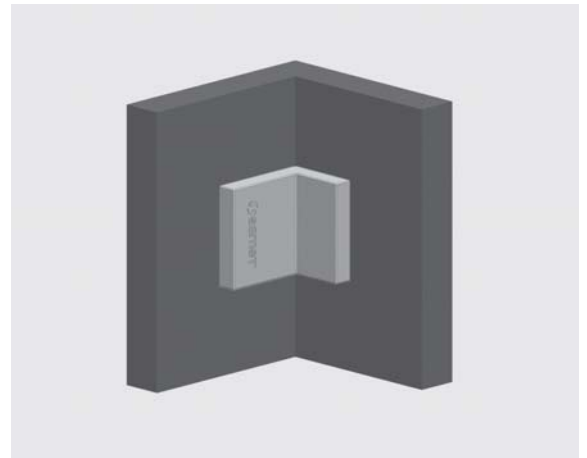

- By the nailed structure, can be used for hanging cabinets.
- Should be applied to the sideways.

* All dimensions in the graphs above are measured in mm.

Code Table

DESCRIPTION	CODE	PACKAGE
Lux Economic L-Type Cabinet Hanger Cherry	1990951	400 Pcs/Box
Lux Economic L-Type Cabinet Hanger Cream	1990952	400 Pcs/Box
Lux Economic L-Type Cabinet Hanger Brown	1990953	400 Pcs/Box
Lux Economic L-Type Cabinet Hanger White	1990954	400 Pcs/Box
Lux Economic L-Type Cabinet Hanger Pear	199095A	400 Pcs/Box
Lux Economic L-Type Cabinet Hanger Grey	199095B	400 Pcs/Box
Lux Economic L-Type Cabinet Hanger Oak	199095S	400 Pcs/Box

Dimensions

